

**1. Strip measures male cable connector**

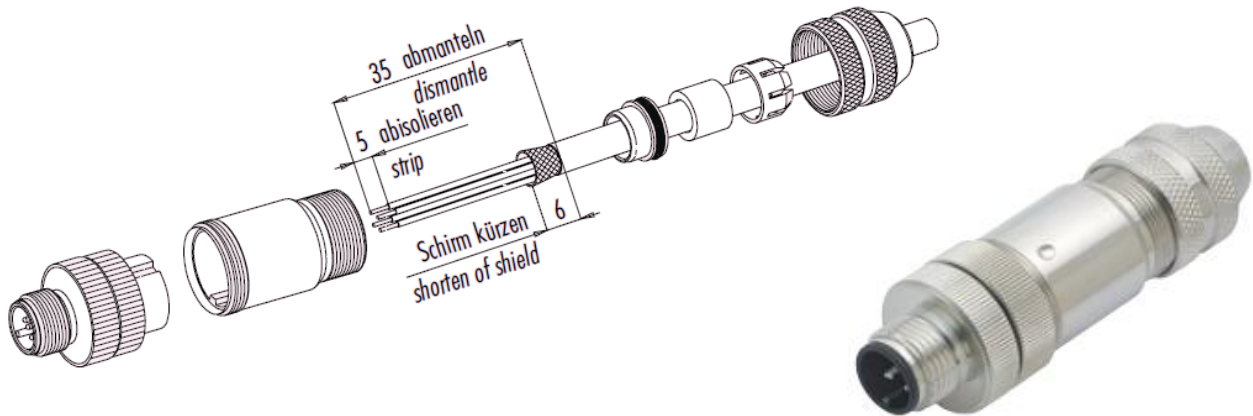

**2. Contact arrangements**

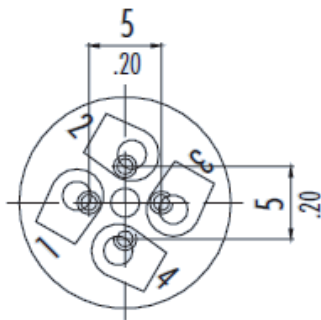

4 pole male cable connector  
(rear view)

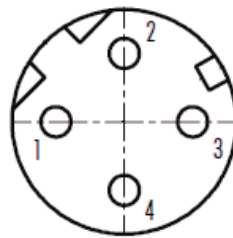

4 pole female socket with wires  
(front view)

- 1 yellow
- 2 white
- 3 orange
- 4 blue

**3. Pin assignment (standardized)**

PROFINET IO, EtherNet/IP, Modbus-TCP	
Pin 1	Tx +
Pin 2	Rx +
Pin 3	Tx -
Pin 4	Rx -

**4. Specifications**

	Cable connector	Socket with wires
Termination	Screw connection	Wires
Wire gauge	max. 0.75 mm <sup>2</sup> (AWG 20)	Wires 0.25 mm <sup>2</sup> (AWG 24)
Degree of protection	IP 67	IP 68
Temperature range	- 25 °C to + 85 °C	
Rated voltage	250 V	
Rated impuls voltage	2500 V	
Rated current (40 °C)	4 A	
Cable outlet	6 – 8 mm	-