



Rotating cleaning nozzle "ACCUClean" Series 515

Series 515

The controlled rotation of the ACCUClean makes cleaning extremely efficient. It cleans with powerful flat jets and can be combined with the Lechler rotation monitoring sensor. It is also offered in versions with different spray angles.



To see video

Scan the QR-code
or go to:
www.lechlerusa.com



Materials
Stainless steel
AISI 316L, PTFE, PEEK

Max. temperature
284°F/ 140°C

Recommended operating pressure
75 psi

Installation
Vertically facing downward

Filtration
Line strainer with a mesh size of 0.3 mm/50 Mesh

Bearing
Ball bearing made of stainless steel

Rotation monitoring sensor
Sensor compatible
Info: see page 68

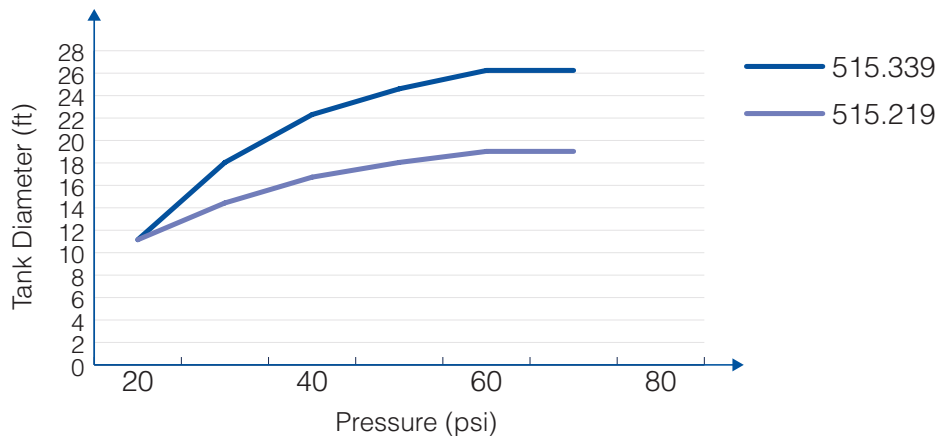



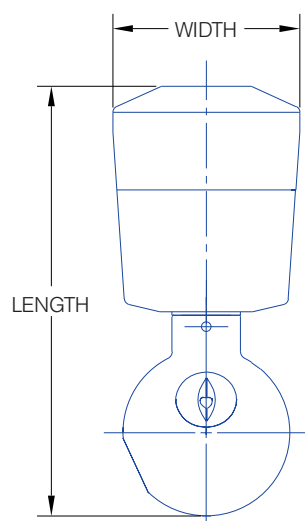



Overview of the tank diameter, depending upon the pressure of series 515



Nozzle dimensions [in]

Type	Height (in.) H	Diam. (in.) Ø D
515.2XX	6.7	3.4
515.3XX	10.5	5.5

Spray angle 	Ordering no.			Free Passage (in.)	Flow Rate (Gallons Per Minute)				Max. tank diameter [ft]	
	Type	Connection			20 psi	liters per minute		40 psi		60 psi
		3/4" Female NPT	1" Female NPT			2 bar	60 psi			
180° 	515. 213. 7T	BL	-	.039	21	97	30	37	19	
180° 	515. 214. 7T	BL	-	.039	21	97	30	37	19	
270° 	515. 215. 7T	BL	-	.039	21	97	30	37	19	
	515. 285. 7T	BL	-	.039	32	145	45	55	22	
270° 	515. 216. 7T	BL	-	.039	21	97	30	37	19	
360° 	515. 219. 7T	BL	-	.039	21	97	30	37	19	
	515. 289. 7T	BL	-	.039	32	145	45	55	22	
	515. 339. 7T	-	BN	.039	42	193	60	73	26	

The maximum tank diameter shown above applies for the recommended operating pressure and is indicative only. The cleaning result is also affected by the type of soiling.

Information on operation

- Operation with compressed air purge only for short-term usage. Operation above the recommended operating pressure means higher wear and smaller droplets. This might have adverse effects on the cleaning result.

Example of ordering:	Type	+	Connection	=	Ordering no.
	515.213.7T.	+	BL	=	515.213.7T.BL