

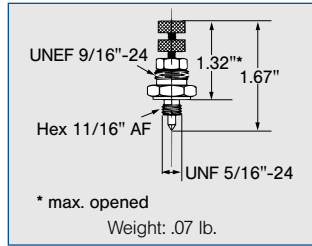

Accessories for the AirMist pneumatic atomizing nozzles Series 136

Regulating device and shut-off needle:

Shuts off flow and controls liquid supply – manually operated

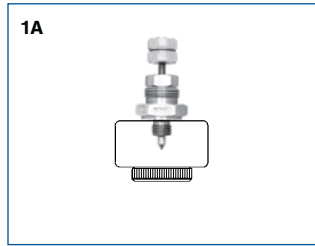

Ordering no.		For all 136 series nozzles
Assembly part no.	Mat. no.	
	303 SS 16	
015. 600	<input type="radio"/>	

Regulating device with quick-cleaning needle:

Combines orifice cleaning with liquid flow control – manually operated

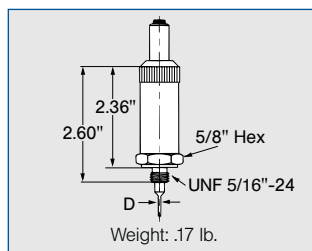
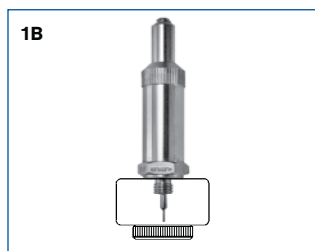

Ordering no.		Use the 6th digit to determine appropriate accessory Example: 136.414.1Y.B2	Needle diameter D (in.)	
Assembly part no.	Mat. no.			
	303 SS 16	Brass Nickel Plate 35		
013. 601. xx. 30	<input type="radio"/>	<input type="radio"/>	136. xx 1 . xx. B2	.085
013. 602. xx. 30	<input type="radio"/>	<input type="radio"/>	136. xx 2 . xx. B2	.048
013. 603. xx. 30	<input type="radio"/>	<input type="radio"/>	136. xx 3 . xx. B2	.034
013. 604. xx. 30	<input type="radio"/>	<input type="radio"/>	136. xx 4 . xx. B2	.024
013. 605. xx. 30	<input type="radio"/>	<input type="radio"/>	136. xx 5 . xx. B2	.016
013. 606. xx. 30	<input type="radio"/>	<input type="radio"/>	136. xx 6 . xx. B2	.012

Quick-cleaning device:

Does orifice cleaning with push-button pin – manually operated

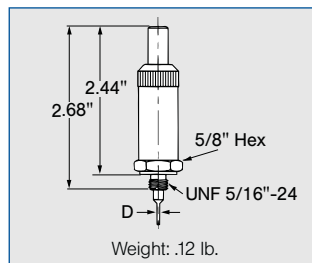
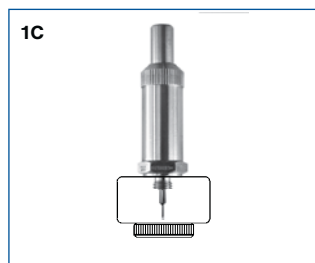

013. 601. xx. 20	<input type="radio"/>	<input type="radio"/>	136. xx 1 . xx. B2	.085
013. 602. xx. 20	<input type="radio"/>	<input type="radio"/>	136. xx 2 . xx. B2	.048
013. 603. xx. 20	<input type="radio"/>	<input type="radio"/>	136. xx 3 . xx. B2	.034
013. 604. xx. 20	<input type="radio"/>	<input type="radio"/>	136. xx 4 . xx. B2	.024
013. 605. xx. 20	<input type="radio"/>	<input type="radio"/>	136. xx 5 . xx. B2	.016
013. 606. xx. 20	<input type="radio"/>	<input type="radio"/>	136. xx 6 . xx. B2	.012

Pneumatically controlled valve:

Opening pressure 30 psi, max. 180 cycles/min. Connects to separate air inlet for fast on/off operation – externally controlled

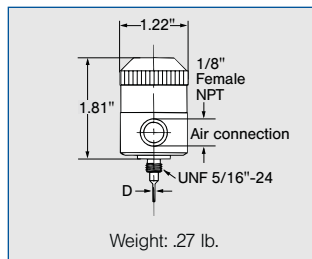
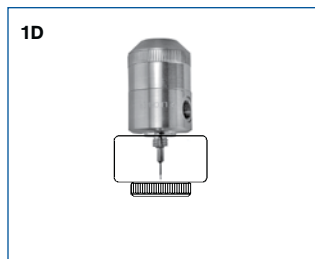

013. 601. xx. 10	<input type="radio"/>	<input type="radio"/>	136. xx 1 . xx. B2	.085
013. 602. xx. 10	<input type="radio"/>	<input type="radio"/>	136. xx 2 . xx. B2	.048
013. 603. xx. 10	<input type="radio"/>	<input type="radio"/>	136. xx 3 . xx. B2	.034
013. 604. xx. 10	<input type="radio"/>	<input type="radio"/>	136. xx 4 . xx. B2	.024
013. 605. xx. 10	<input type="radio"/>	<input type="radio"/>	136. xx 5 . xx. B2	.016
013. 606. xx. 10	<input type="radio"/>	<input type="radio"/>	136. xx 6 . xx. B2	.012

Example for ordering:	Type	+	Material no. (xx)	=	Ordering no.
	013. 602. xx. 20	+	16	=	013. 602. 16. 20

1E for Series 136/166
Locking plug
156. 000. 1Y. 00. 04

2A for Series 136
Seal
095. 015. 7A. 03. 04

3A for Series 136/166
Lockring
136. 000. 1Y. 00. 07

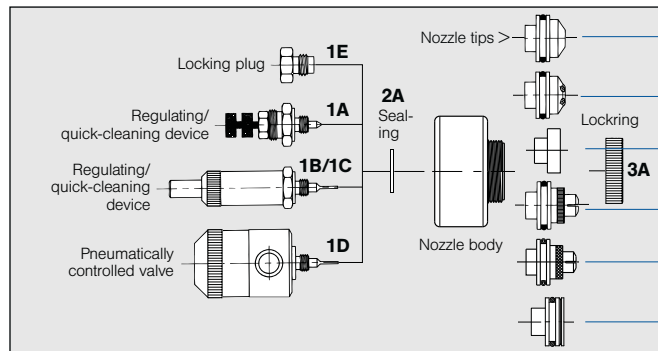

Nozzle tips*

- Series 136.1/166.1
136. xxx. 1Y. 00. 03
- Series 136.2/166.2
136. xxx. 1Y. 00. 03
- Series 136.3/166.3
136. xxx. 1Y. 00. 03
- Series 136.4/166.4
136. xxx. 1Y. 00. 03
- Series 136.5/166.5
136. xxx. 1Y. 00. 03
- Series 136.6/166.6
136. xxx. 1Y. 00. 03

* Use the 3 digits from the full nozzle assembly for the spare tip part number
Example:
136.414.17.B2

