

# Exploded View

Hand demountable and easy slide models are easily dismantled for cleaning via the endplate handwheels.

Shaftseals are inspected / replaced via 2 knurled thumbnuts.

USDA Accepted Design

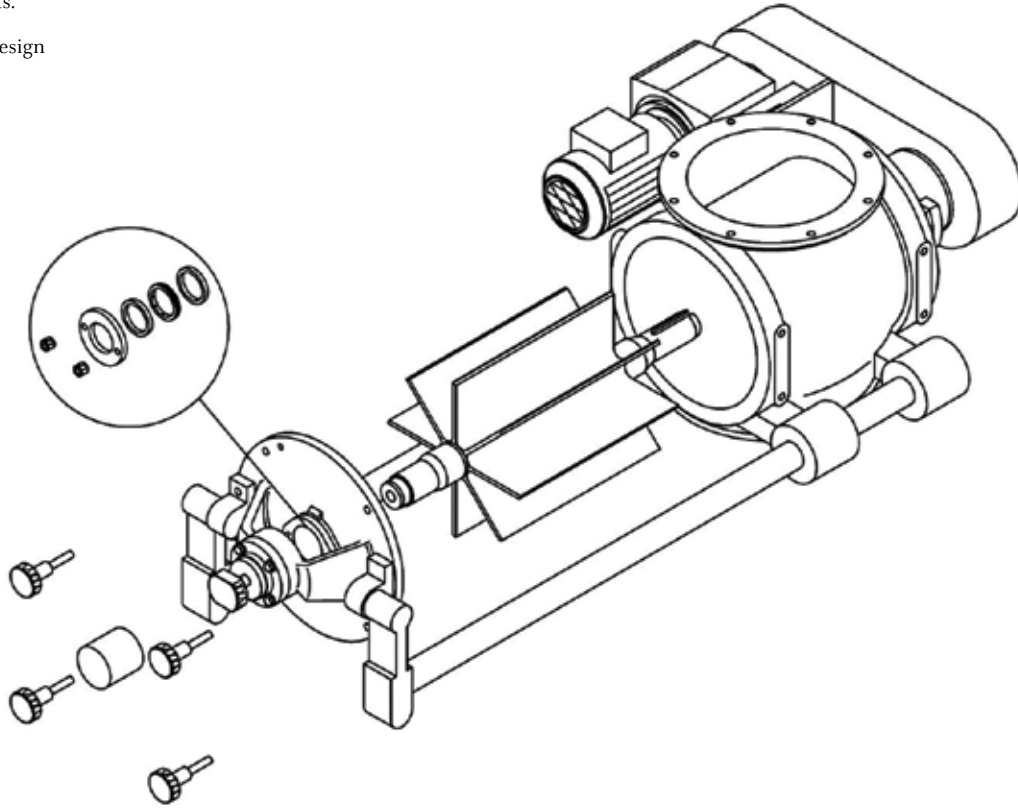

# Technical Data

Valve Capacity Chart

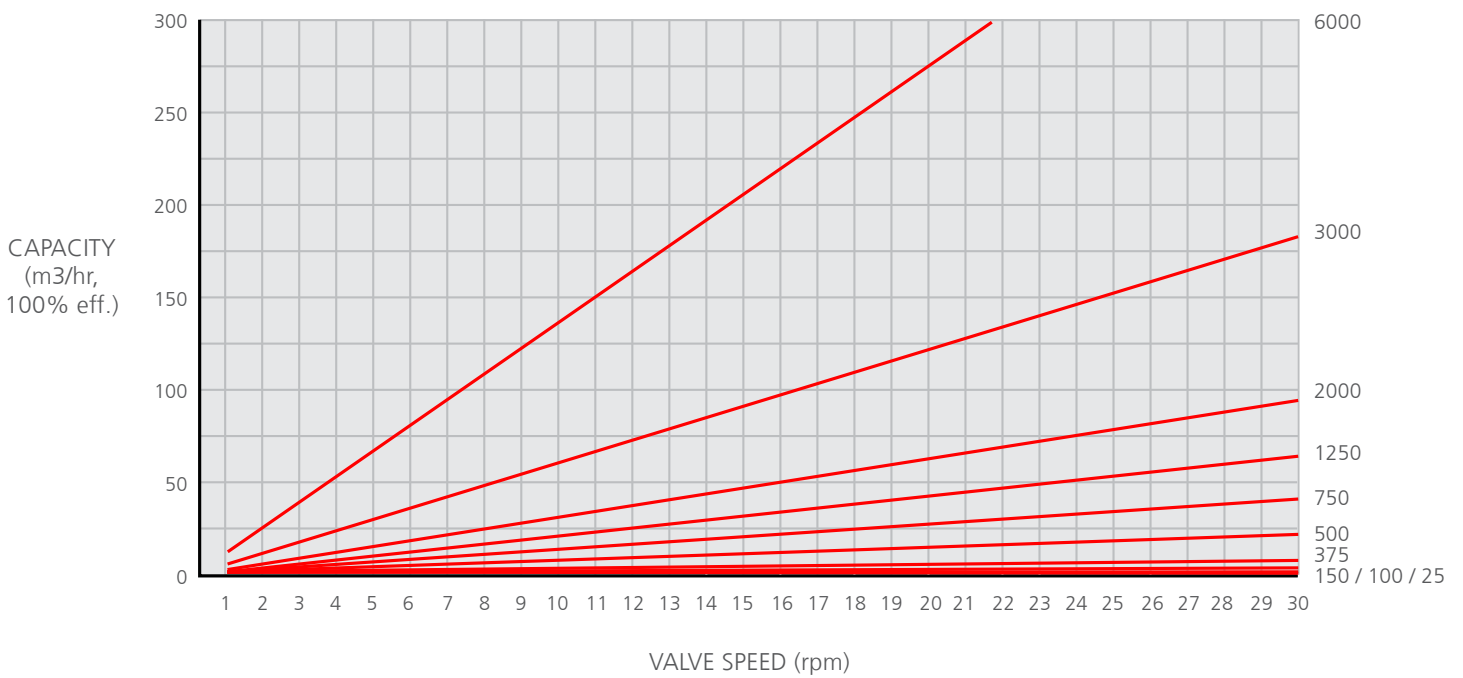

*We live our values.*

Excellence • Passion • Integrity • Responsibility • GEA-versity

GEA Group is a global engineering company with multi-billion euro sales and operations in more than 50 countries. Founded in 1881, the company is one of the largest providers of innovative equipment and process technology. GEA Group is listed in the STOXX® Europe 600 Index.



**GEA Avapac Ltd.**

12-18 Foreman Road, PO Box 10266, Te Rapa, Hamilton 3241,  
New Zealand

Tel: +64 7 849 3414, Fax: +64 7 849 3494

[info.avapac.nz@gea.com](mailto:info.avapac.nz@gea.com)

**GEA Nu-Con Ltd.**

8 Fisher Crescent, Mt Wellington, PO Box 12-264, Penrose,  
Auckland 1642, New Zealand

Tel: +64 9 276 2388, Fax: +64 9 259 0172

[sales.nucon.nz@gea.com](mailto:sales.nucon.nz@gea.com)

**GEA Process Engineering B.V.**

Munsterstraat 5, 7418 EV Deventer  
Postbus 2064, 7420 AB Deventer, Netherlands

Tel: +31 570 663 366, Fax: +31 570 663 377

[info.gpnl.nl@gea.com](mailto:info.gpnl.nl@gea.com)

**GEA Process Engineering Inc.**

1600 O'Keefe Road, Hudson, Wisconsin 54016,  
United States of America

Tel: +1 715 386 9371, Fax: +1 715 386 9376

[gea-pe.us@gea.com](mailto:gea-pe.us@gea.com)



## Rotary Valves

# Rotary Valves

## Overview

GEA Nu-Con rotary valves and airlocks are designed to suit a diverse range of pneumatic conveying and product metering duties.

Rigid quality control and machining tolerances to suit specific products assures highest efficiency and years of trouble free operation.

A wide range of rotary valves are available for use in dairy, food, pharmaceutical, nutritional products and other dry bulk materials.

Also available are options and adaptations to suit every application from general industrial duties, to hygienic processes.

GEA Nu-Con have developed an extensive range of options to ensure that the optimum configuration is supplied to meet the specific requirements.

## Function

A rotary valve or airlock is used to feed powdered or granular solids between areas of differing pressure while still maintaining the pressure differential and product flow.

- Precision Engineering
- Quality Manufacturing
- Service
- Experience
- Commitment
- Reliability

## Compliance Options

- ATEX
- Explosive Protective System - EN 15839
- USDA

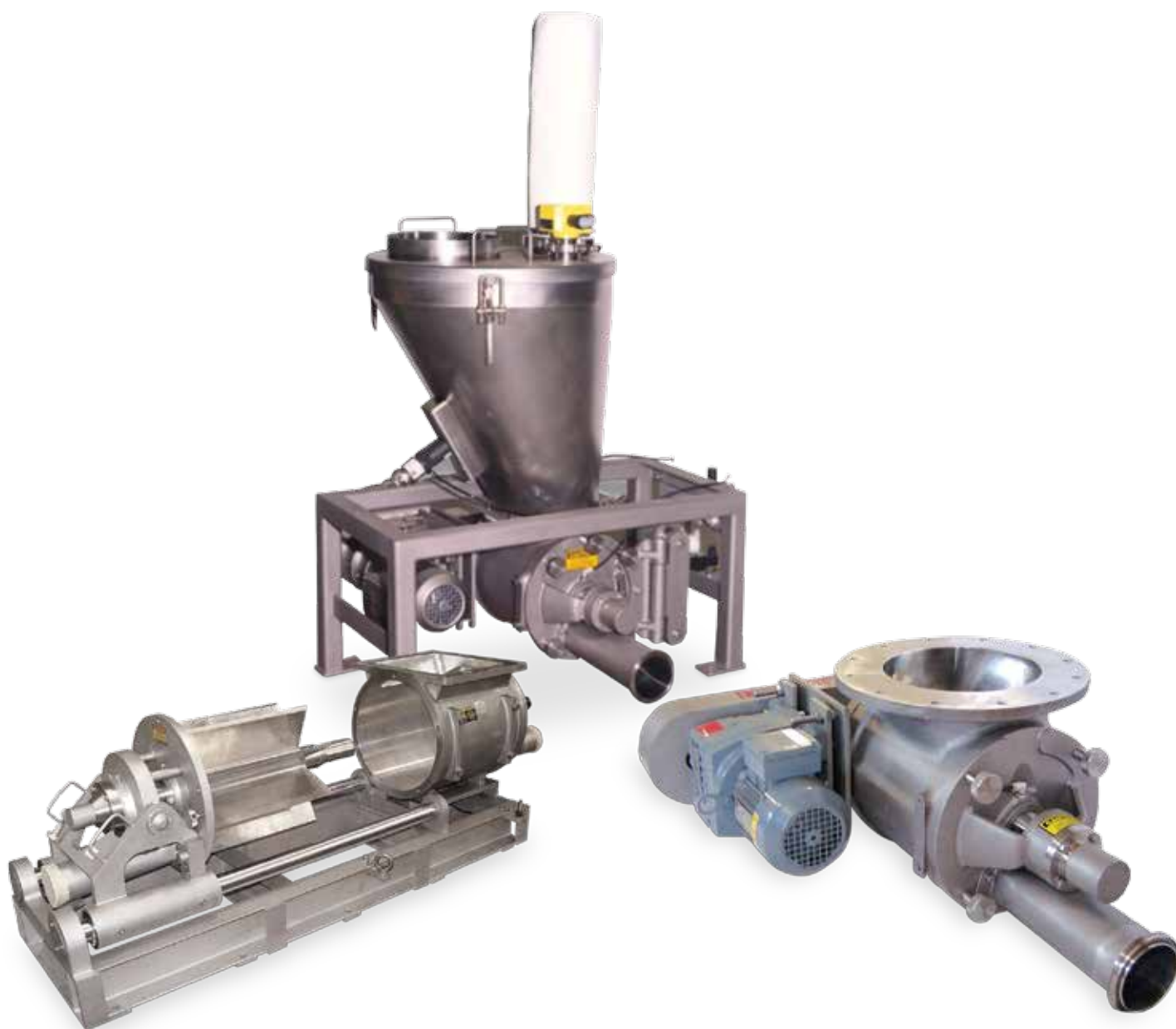



C Series  
General purpose valve



Demountable  
Hand demountable easy-clean valve



Easy Slide - Base Mounted  
Rotor support system



Easy Slide - Side Mounted  
Rotor support system



High Pressure  
High differential pressure duties



Mini Rotary Valves  
Low capacity metering duties



B Series  
Economical low pressure valve



Rotor Detection System - RDS  
Rotor Detection System automatically detects any contact between rotor and housing for ultimate safety. Custom designed models available for specialised applications.

## Valve Configurations



a) Blow through (CV)  
Product discharges horizontally at 90° to inlet via a pneumatic conveying line, either vacuum or pressure.

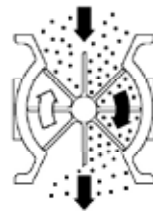

b) Drop through (DT)  
Product discharges vertically downwards from the bottom outlet.

## Rotor Types



**Sanitary Rotor**  
Scalloped rotor with radiused corners prevents product buildup

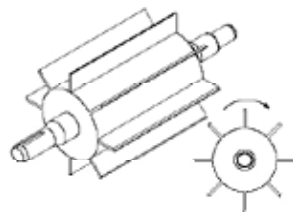

**Reduced Capacity Rotor**  
For specialised metering applications

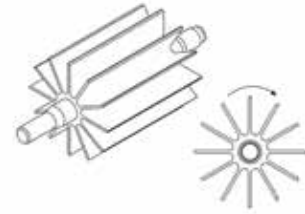

**Multi Vane Rotor**  
Provides accurate dosing and reduces air leakage

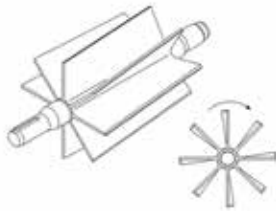

**Helical Rotor**  
Shearing action against valve body

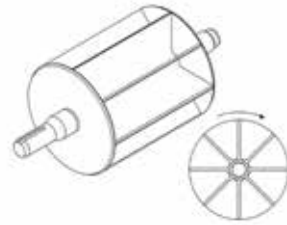

**Disc-end Rotor**  
Protects endplates and shaftseals for abrasive applications

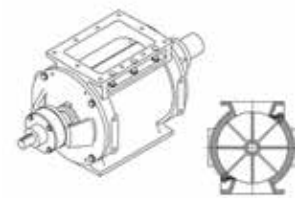

**Knife Blade**  
Provides shearing action against rotor blade for fibrous materials



**USDA Plastic Rotor**  
Non-stick surface for sanitary applications

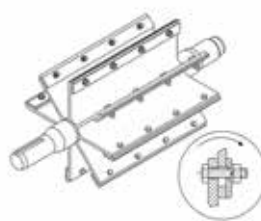

**Replaceable Tips**  
Hardened materials for abrasive applications

Also available:  
Coated / jacketed rotors  
Stellite /Bevelled/square tips  
and many more.

## Optional Accessories



**Vented Valve**  
Exhausts trapped air prior to product inlet.

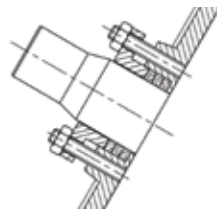

**Packed Gland Shaftseal**  
Standard shaftseal design for general purpose applications.

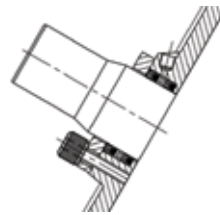

**Air Purged Shaftseal**  
Hand demountable seal for sanitary applications.

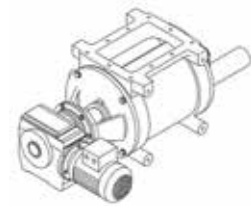

**Direct Drive Units**  
Economical option eliminates need for sprockets & chaindrive.

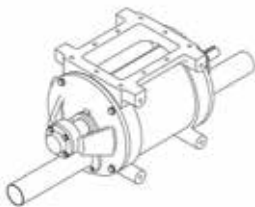

**Rectangular Inlet**  
Maximises inlet opening for non-free flowing materials.



**Pellet Deflector**  
Prevents product damage for pelleted and lumpy materials



**Convey Transition**  
Feeds material into airstream to assist conveying.



**Feed Hopper**  
Efficiently feeds powder into the valve inlet.

### PLUS:

Rotor Detection System; Rotor speed monitoring; CIP (Cleanable-in-place) systems; ATEX Rated valves; cast iron, carbon/stainless steels and special alloys available; painted, polished and beadblasted finishes; low friction and abrasion resistant linings/coatings; air service units; ANSI/BS/DIN/JIS flanges; additional safety switches/features and customised valves.