

18TS

Inline Top-Seal Carton Closer

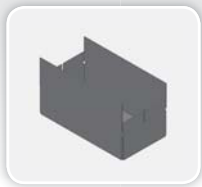

where products meet packaging®

Featuring positive, continuous motion lugged carton transfer design, the ADCO 18TS is a perfect solution for inline sealing of top-seal, RSC and tablock cartons. With its simple design and ability to handle wide variety of carton shapes and sizes at variable speeds up to 60 cartons per minute, the versatile 18TS is packed with value. Cartons arrive back-to-back and are indexed into the 18TS by either an air-actuated push-off indexer or a dual-lugged mechanical indexer. ADCO's lugged transfer design maintains control of the carton all the way through the closing and sealing operation. This reliable and simple to operate carton closer is ideal for the most demanding and cost conscious production environments. Like all ADCO machines, the 18TS is constructed in stainless steel and is available in standard or washdown configurations.

Benefits

- Stainless steel construction improves cleanability
- Positive, continuous motion lugged carton transfer maximizes control and reliability
- Lugged side chain design maximizes carton squaring and product quality
- Fast, easy changeover improves productivity and reduces downtime
- Large carton size and style range with protects your investment as products change
- Advanced guard design keeps operators safe and maximizes maintenance access

18TS Inline Top-Seal Carton Closer

Product Features

- Stainless steel construction
- Air-actuated push-off indexer or mechanical dual-lugged indexer
- Lugged carton transfer system
- Powered discharge belts
- Variable speed drive system
- Dust flap tucking system
- Compact frame with leveling feet and casters
- Capable of closing tablock style or glued cartons
- Nordson® ProBlue hot melt glue system (when glue is specified)
- Allen-Bradley® control package
- Category 3 safety system with a fully-interlocked barrier guard package
- Cover right or left
- Many options available upon request

Typical Applications

- Personal care
- Flow-wrapped products
- Frozen foods
- Snack foods
- Baked goods
- Household products

Utilities

Electrical

230/460 VAC, 3-Phase with ground (PE), 60 Hz

Air Consumption

2-3 SCFM @ 65-70 PSI

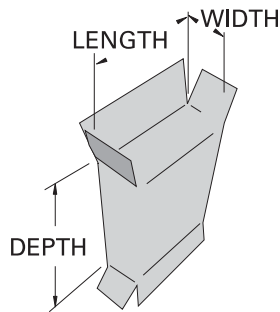

PLAN VIEW

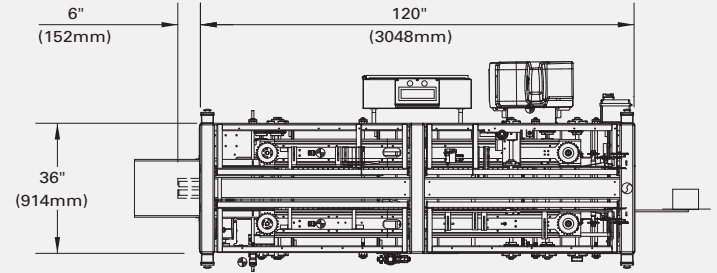

SIDE ELEVATION

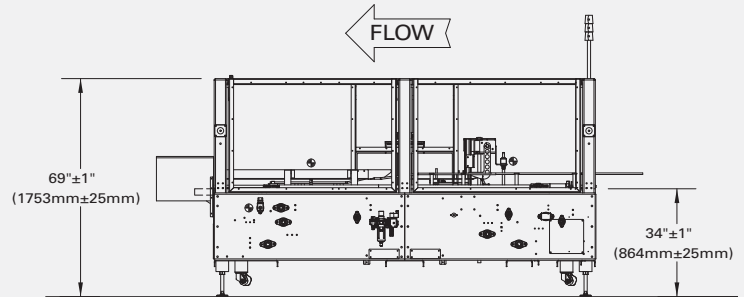

CARTON SIZE RANGE

Dimensions	(in)		(mm)	
	Min	Max	Min	Max
Length	4	12	100	305
Width	4	10	100	255
Depth	1.5	6	40	150

Not all minimums and maximums apply.
Special modifications are available to extend the size range.



For more information on this product, scan the QR code with your mobile device.