

JTGHF 大流量液体过滤器 Large Flow Liquid Filter

超大流量工业级过滤器
Super large industrial-Grade Filter

典型的应用

- 流量较大的场合，特别是水处理领域。

Application

- Mainly used in some large flow situation, especially water treatment field

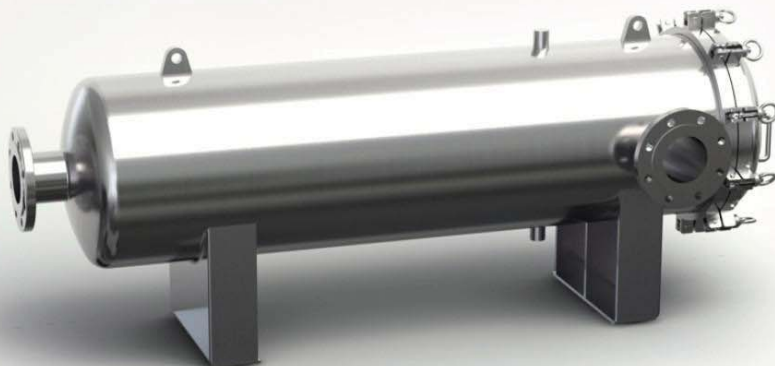
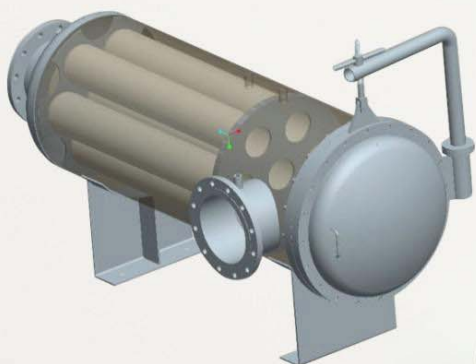

● JTGHF大流量液体过滤器，又名JTGHF大胖过滤器是针对于大口径和高流速的管道而开发，适用于高通量的工况，其芯件采用折叠式大流量滤芯，相当于传统普通冲孔蓝式滤芯和棒式折叠式滤芯多倍面积；其大于50%的开孔率与直通式结构，组合出最大的流量和最小的压差，大大降低了总体的尺寸和重量，从而减少了投资成本及运行成本，也降低滤芯更换的频率，节约了劳动力资源。

● JTGHF大流量液体过滤器分立式和卧式两种，常规20"、40"滤芯的过滤器通常采用立式结构；超过1000吨/小时流量的中大系统，选择卧式结构，并配备60"的滤芯使用，满足大流量的同时，降低滤芯更换次数，更换滤芯更方便。

● JTGHF industrial-grade liquid filter is mainly used in some larger flow situation, especially water treatment field. JTGHF big flow liquid filter characterizes of big connect size, high flux and small occupation area. It can effectively solve the traditional filter problem high costs input, the long replacement time, trouble operation and so on.

● JTGHF big flow liquid filter have two installation types like vertical and horizontal. 20' and 40' filters usually adopt vertical structure, the flow of medium system more than 1000T/H chooses horizontal structure and is equipped with 60" filter cartridge, meeting the large flow rate at the same time to reduce the the number of times of cartridge replacement. It is more convenient to replace filter cartridge.

产品特点

- 流量大、占地面积小、效率高。
- 304和316L两种不锈钢可供选择，良好的耐腐蚀性能，能满足各领域的要求。
- 立式和卧式两种结构可供选择。

Feature

- Super large flow, small occupation area, high efficiency.
- 304 and 316 l stainless steel are available, good corrosion resistance, meeting the requirements of various fields.
- Vertical and horizontal structures can be chose.

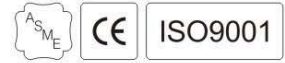

常规结构 Structure

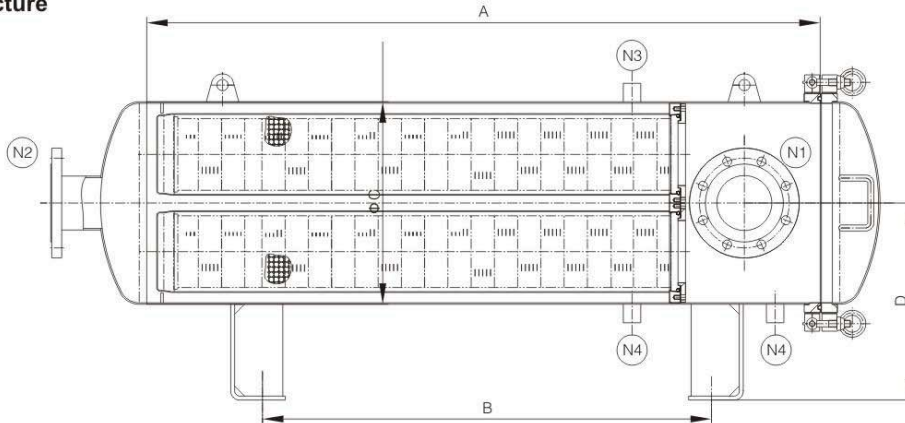

大流量液体过滤器(大胖过滤器) Large flow liquid filter

操作条件 Operating Conditions

最大操作压力 Max operating pressure	0.6MPa、1.0MPa
最大操作温度 Max operating temperature	150°C

表面处理 Surface Finish

处理类型 Finish type	机械抛光、电解抛光 Mechanical / Electrolytical polishing
抛光精度 Polishing precision	内壁 0.3 μm Inner surface Ra≤0.6 μm 外壁 0.4 μm Outside surface Ra≤0.8 μm

材料 Material

过滤器壳体 Shell	304、316L
排气液阀 Vent/ Drain valve	304、316L
吊环螺栓 Eyebolt	304
支脚 Stabilizer blade	304
密封圈、垫片 O-ring	三元乙丙橡胶、聚四氟乙烯、 氟橡胶、硅橡胶 EPDM, PTFE, Viton, Silicone

连接 Connection

壳体连接 Connection of shell	法兰 Flange
进出口N1、N2 In-outlet	快装、法兰 Flange, Tri-clamp
压力表N3(选配) N3 Pressure gauge (option)	G3/4"螺纹 Thread
排气阀N4(选配) N4 Vent valve (option)	G1/2"螺纹 Thread

尺寸参数表 Dimension Parameters

	1芯 (1R)			2芯 (2R)		
	20"	40"	60"	20"	30"	40"
A: 壳体长度(不含封头) Shell length (exclude head)	700	1200	1700	800	1300	1800
B: 支座固定螺栓孔中心距 Support center distance	300	600	900	400	700	1000
C: 直径 Shell diameter	Φ230			Φ400		
D: 进出口N1、N2离地高度 The height form In-outlet N1, N2	355			395		
进出口N1、N2尺寸 In-outlet N1、N2 size	2"/2.5"/3"			3"/4"/5"		

上表数据为标准型大流量液体过滤器(卧式), 可根据客户要求定制, 未注长度单位为mm。
The above-mentioned data is the standard, it can customize according to customer's requirements.

JTGHF 选型表 Selection Table

[结构形式 Type of construction]	[滤芯数量 Qty. of cartridge]	[滤袋型号 Model of Bag Filter]	[壳体材料 Shell Material]	[进出口连接 In-outlet connection]	[密封圈 O-ring]
L	2R	20	4	K	E
L=立式 Vertical	1R=1芯 Pcs	20=20" 滤芯 Cartridge	4= 304	K=快装 Tri-clamp	E=三元乙丙橡胶 EPDM
W=卧式 Horizontal	2R=2芯 Pcs	40=40" 滤芯 Cartridge	6= 316L	E=法兰 Flange	P=聚四氟乙烯 PTFE
	3R=3芯 Pcs	60=60" 滤芯 Cartridge		L=螺纹 Screw thread	V=氟橡胶 Viton
	4R=4芯 Pcs				S=硅橡胶 Silicone
	5R=5芯 Pcs				